

500 / 501 PARTS DRAWING

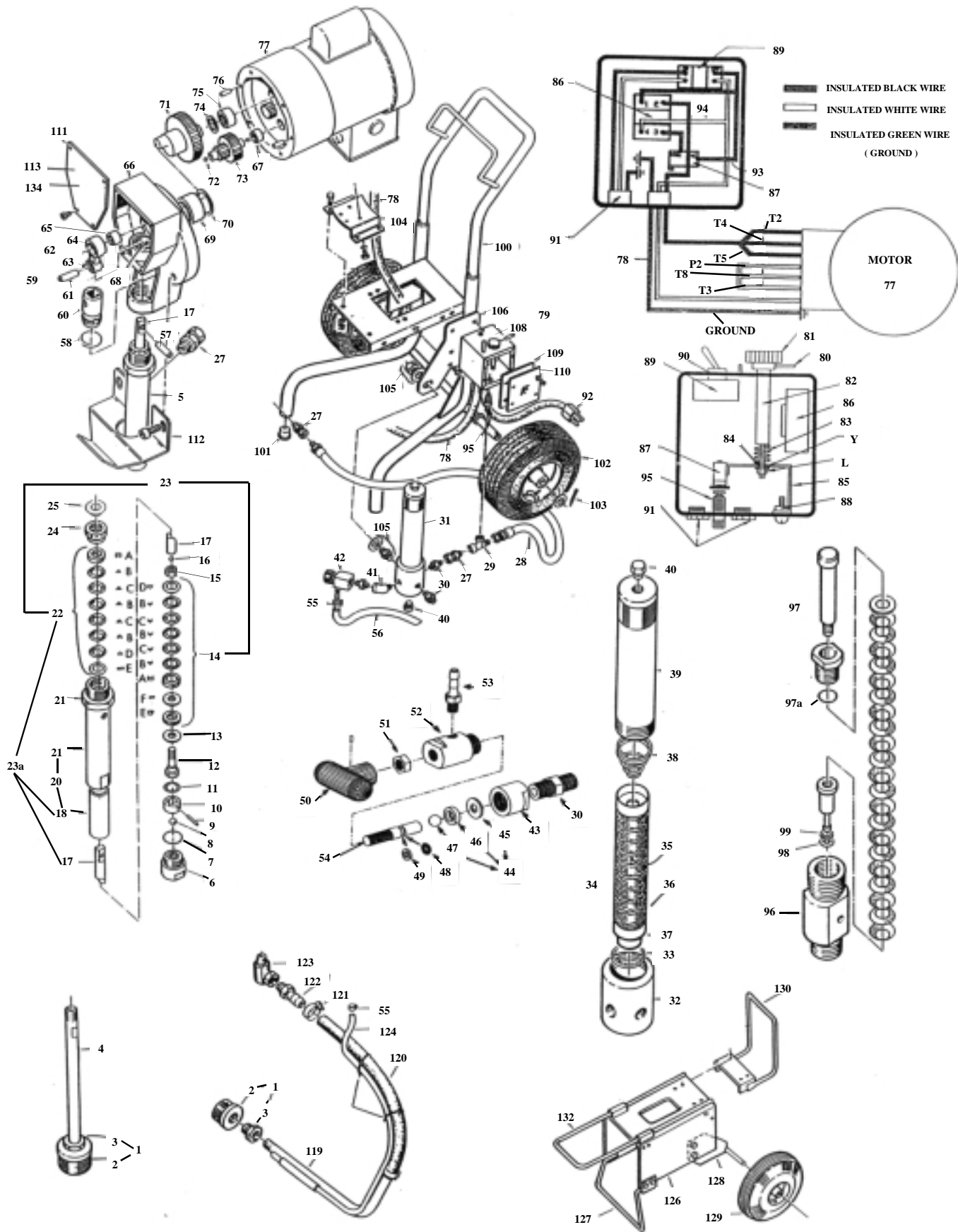

PISTON POWER 500 / 501

REF #	PART #	DESCRIPTION	REF #	PART #	DESCRIPTION
1	4-187A	SYPHON SCREEN, C/W ADAPTER (REF #2&3)	62	4-05-40-5500	CON-ROD ASSMEBLY, (REF # 63-65)
2	187F	SYPHON SCREEN	63	05-40-5004	CON-ROD BUSHING
3	187-5	SYPHON SCREEN ADAPTER	64	05-40-5005	CON-ROD
4	02-40-2000	INTAKE TUBE	65	05-40-5006	CON-ROD BEARING
5	4-02-40-2500	FLUID SECTION ASSEMBLY, REF # (6-27)	66	4-05-40-5501	DRIVE HOUSING ASSEMBLY, (REF #67-69)
6	02-40-2001	INTAKE HOUSING, WITH SEAT	67	05-40-5009	REDUCER SHAFT BEARING
7	02-40-2003	O-RING	68	05-40-5010	CROSSHEAD BUSHING
8	02-40-2004	BALL	69	05-40-5011	CRANKSHAFT BEARING
9	02-40-2005	BALL GUIDE PIN	70	05-40-5012	FRONT CRANKSHAFT THRUST WASHER
10	02-40-2006	BALL GUIDE	71	4-05-40-5522	CRANKSHAFT ASSEMBLY, (1725 RPM)
11	02-40-2007	CRUSH WASHER	72	667-43-3	1/4" DRIVE BALL
12	02-40-2008	PISTON HOUSING WITH SEAT	73	4-05-40-5523	REDUCER SHAFT ASSEMBLY, (1725 RPM)
13	02-40-2010	PISTON VALVE BACK-UP WASHER	74	05-40-5015	REAR CRANKSHAFT THRUST WASHER
14	4-02-40-2509	LOWER PACKING SET, PISTON VALVE	75	05-40-5016	CRANKSHAFT BEARING
15	02-40-2017	PISTON VALVE PACKING NUT	76	05-40-5020	DRIVE HOUSING LOCATOR PIN
16	02-40-2018	PISTON VALVE BALL	77	4-05-500-360	MOTOR, 500/501, C/W (REF # 67, 75)
17	4-02-40-2019	PISTON ROD	78	4-05-40-5507	MOTOR CORD ASSEMBLY
18	4-02-40-2020	CYLINDER SLEEVE	79	4-05-40-5520	CONTROL BOX ASSEMBLY, (REF #27,29,80-95,110)
19	02-40-2021	CYLINDER WITHOUT SLEEVE	80	05-40-5026	PRESSURE CONTROL KNOB PIN
20	4-02-40-2506	CYLINDER ASSEMBLY, (REF # 19 & 20)	81	05-40-5027	PRESSURE CONTROL KNOB
21	02-40-2022	CYLINDER LOCK NUT	82	05-40-5028	ADJUSTMENT POST
22	4-02-40-2503	UPPER PACKING SET, CYLINDER	83	05-40-5029	ADJUSTMENT POST SPRING
23	4-02-40-2510	PACKING REPAIR KIT, (REF # 7, 8, 11, 13, 14, 16, 22)	84	05-40-5030	ADJUSTMENT POST BUSHING
23a	4-02-40-2525	OVERHAUL KIT, (REF # 17, 18, 23)	85	05-40-5033	MICROSWITCH BRACKET MOUNT
24	02-40-2027	CYLINDER PACKING NUT	86	05-40-5041	SOLID STATE RELAY
25	02-40-2028	CYLINDER THROAT PLUG	87	05-40-5047	MICROSWITCH
26	4-02-40-3PL1	PACKING LUBRICANT 8 oz. (NOT SHOWN)	88	05-40-5050	MICROSWITCH MOUNT
27	20	SWIVEL CONNECTOR	89	65/102	ON/OFF SWITCH
28	03-40-3000	HOSE	90	65/110	ON/OFF PLATE
29	03-40-3001	PRESSURE SENSOR TEE	91	65/111	1/2", 2 SCREW CONNECTOR
30	14A	1/4" X 1/4" MALE CONNECTOR	92	4-05-40-5508	AC POWER CORD ASSEMBLY
31	4-03-40-3500	MANIFOLD FILTER ASSEMBLY,(REF # 32 - 39)	93	4-05-40-5512	2 TERMINAL WIRE ASSEMBLY
32	03-40-3002	LOWER MANIFOLD HOUSING	94	4-05-40-5513	3 TERMINAL WIRE ASSEMBLY
33	03-40-3003	MANIFOLD O-RING	95	4-05-40-5544	PRESSURE SENSOR ASSEMBLY, (REF # 96,97), REPLACES # 4-05-40-5504
34	4-03-40-3501	FILTER SCREEN ASSEMBLY, (REF # 35-37)	96	05-40-5059	PRESSURE SENSOR HOUSING,(HEX BODY) REPLACES # 05-40-5039, (SQUARE BODY)
35	03-40-3005	FILTER SPRING	97	4-05-40-5505	PRESSURE SENSOR STEM ASSEMBLY, (REF # 98-99)
36	03-40-3006	MANIFOLD FILTER, 60 MESH	97a	77175VI	PRESSURE SENSOR NUT O-RING
37	03-40-3011	FILTER SCREEN INSERT	98	05-40-5042T 05-40-5060E 05-40-5060	SENSOR O-RING, (THIOKOL), HEX BODY SENSOR O-RING, (EPDM), SQUARE BODY SENSOR O-RING, (THIOKOL), SQUARE BODY
38	03-40-3008	FILTER SCREEN SPRING	99	05-40-5038	SENSOR BACK-UP WASHER, (NOT USED) USE 2 SENSOR O-RINGS
39	03-40-3009	UPPER MANIFOLD HOUSING	100	4-06-600-457	500 CART, C/W HANDLE
40	13A	MANIFOLD PLUG	101	06-40-6004	GLIDE
41	03-40-3010	45 DEGREE ELBOW	102	06-99-0002	12" PNEUMATIC WHEEL
42	4-606	PRIME VALVE ASSEMBLY (REF # 43-54)	103	67/16	COTTER PIN
43	606-2	PRIME VALVE NUT	104	4-06-600-452	MOTOR MOUNT
44	4-606RK	PRIME VALVE REPAIR KIT (REF # 45 - 47)	105	4-06-40-6509	MANIFOLD FILTER MOUNT ASSEMBLY
45	11A-3CP	COPPER CRUSH WASHER	106	4-06-40-6513	CONTROL BOX MOUNTING PLATE
46	11A-4	3/8" TUNGSTEN CARBIDE SEAT	107	4-06-40-6518	CONTROL BOX BRACE
47	11A-5S	3/8" CORROSION RESISTANT SEAT	108	06-40-6016	CONTROL BOX HOUSING
48	606-8	VALVE STEM O-RING	109	06-40-6020	CONTROL BOX GASKET
49	606-15	VALVE STEM BACK-UP WASHER	110	4-06-40-6514	CONTROL BOX COVER
50	4-606-9	PRIME VALVE "T" HANDLE, COMES WITH PIN	111	4-06-40-6506	DRIVE HOUSING COVER
51	HW4053	"T" HANDLE 3/8" HEX JAM NUT	112	4-06-40-6507	PAIL HOOK
52	606-1	PRIME VALVE HOUSING	113	DEC-500	MODEL 500 PISTON POWER DECAL
53	603-6	HOSE BARB	114	DEC-MAXPSI	"MAXIMUM PRESSURE" ROUND DECAL
54	603-12	DECAL, "CLOSE TIGHTLY AFTER PRIME", NOT SHOWN	115	DEC-1/2GPM	"1/2 GPM", 500 / 501 MODELS
55	196	PRIME HOSE CLAMP	116	DEC-PPWARN	WARNING LABEL
56	4-03-40-3502	8" PRIME HOSE, 500 MODEL ONLY	117	DEC-G.STRP	GOLD & BLACK PIN STRIPE DECAL
57	05-40-5001	CON ROD PIN			
58	05-40-5000	RETAINING SPRING			
59	4-05-40-5514	CON-ROD & CROSSHEAD, (REF #58,60-62)			
60	05-40-5055	CROSSHEAD COUPLER			
61	4-05-40-5517	CON ROD PIN			

PISTON POWER 500 / 501

MODEL 501 ITEMS		
REF #	PART #	DESCRIPTION
118	4-02-601-062	SYPHON HOSE ASSEMBLY (REF # 1,56,58,124-127,129)
119	189A-1	5 GAL, SYPHON TUBE
120	4-02-601-063	SYPHON HOSE, 38"
121	1/75-3	HOSE CLAMP
122	667-27	HOSE BARB
123	667-26	INTAKE ELBOW
124	4-03-601-152	PRIME HOSE, 87"
125	188	HOSE TIE
126	4-06-601-453	MODEL 501 CHASSIS
127	4-06-604-454	MODEL 501 FRONT LEG
128	4-06-601-455	MODEL 501 AXLE
129	06-99-0003	8" PNEUMATIC WHEEL
130	06-99-0007	HANDLE / FAN GUARD
131	4-06-40-6510	BRACKET FOR REF # 130, **HIDDEN**
132	06-401-402	MODEL 501 SLIDING HANDLE
133	06-40-6007	HANDLE SPACER, **NOT SHOWN**
134	DEC-501	501 DECAL
A	HW1020	CAPSCREW, HEX HEAD, 1/4 NC X 3/4, GR.5
B	HW1060	CAPSCREW, HEX HEAD, 5/16 NC X 3/4, GR.5
C	HW3011P	MACHINE SCREW, 6-32 X 1, ROUND HEAD
D	HW3013P	MACHINE SCREW, 10-24 X 1/2, RD HEAD SLOT
E	HW3014P	MACHINE SCREW, 10-24 X 5/8, RD HEAD SLOT
F	HW3034P	MACHINE SCREW, 8-32 X 5/8, RD HEAD SLOT
G	HW3040P	MACHINE SCREW, 10-32 X 5/8, RD HEAD SLOT
H	HW3059P	BUTTONHEAD SCREW, 1/4 NC X 1/2, BLACK
I	HW3065P	SHEET METAL SCREW, #14 X 1/2, SLOT
J	HW3066P	SHEET METAL SCREW, #14 X 3/4, SLOT
K	HW4008P	HEX NUT, 6-32
L	HW4009-1P	HEX NUT, 10-24
M	HW4009P	HEX NUT, 8-32
N	HW4010P	HEX NUT, 10-32
O	HW4020	HEX NUT, 1/4 NC, BLACK
P	HW4030	HEX NUT, 5/16 NC, BLACK
Q	HW4061P	HEX NUT, 7/16 NF
R	HW5005P	#6 SHAKEPROOF INTERNAL LOCK WASHER
S	HW5008P	#8 SHAKEPROOF INTERNAL LOCK WASHER
T	HW5010P	3/16" SHAKEPROOF INTERNAL LOCK WASHER
U	HW5040	1/4" REGULAR LOCK WASHER
V	HW5060	5/16" REGULAR LOCK WASHER
W	HW5080	1/2" REGULAR LOCK WASHER
X	HW5105P	3/4" SAE WASHER
Y	10-A7-21	10-24, NYLON INSERT LOCKNUT
Z	3	5/16" NC X 1-3/4 SOCKET HEAD CAPSCREW